



Conexiones de Hierro Maleable



www.cifunsa.com

Catálogo de productos

Las dimensiones están listadas en las páginas siguientes debajo de cada artículo expresadas en pulgadas solo para propósito de estimación. Sujetas a cambios sin previo aviso.



Av. San Sebastián #500, Col. Villa San Sebastián, Guadalupe, N.L., C.P. 67184, Tel: 81-8317-4071



Tee Reforzada

Tees Banded

150 lbs.

Hierro maleable

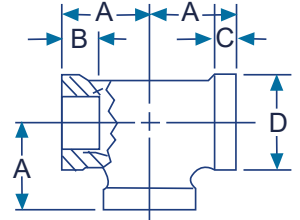

Negro	MEDIDA	A	B	C	D	Galvanizado
CN7116	1/4"	0.810	0.320	0.210	0.840	CG7116
CN71110	3/8"	0.950	0.360	0.230	1.010	CG71110
CN71113	1/2"	1.120	0.430	0.250	1.200	CG71113
CN71119	3/4"	1.310	0.500	0.270	1.460	CG71119
CN71125	1"	1.500	0.580	0.300	1.770	CG71125
CN71132	1 1/4"	1.750	0.670	0.340	2.150	CG71132
CN71138	1 1/2"	1.950	0.700	0.370	2.430	CG71138
CN71150	2"	2.250	0.750	0.420	2.960	CG71150
CN71163	2 1/2"	2.700	0.920	0.480	3.590	CG71163
CN71175	3"	3.080	0.980	0.550	4.280	CG71175
CN711100	4"	3.790	1.080	0.660	5.400	CG711100

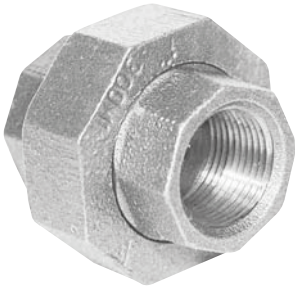

Tuerca Unión

Unions, brass to iron seat

150 lbs.

Hierro maleable

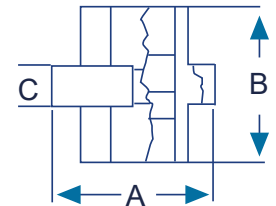

Negro	MEDIDA	A	B	C	Galvanizado
CN7336	1/4"	1.290	1.440	0.560	CG7336
CN73310	3/8"	1.440	1.610	0.630	CG73310
CN73313	1/2"	1.760	1.790	0.700	CG73313
CN73319	3/4"	1.960	2.020	0.712	CG73319
CN73325	1"	2.160	2.120	0.780	CG73325
CN73332	1 1/4"	2.750	2.260	0.860	CG73332
CN73338	1 1/2"	2.990	2.440	0.880	CG73338
CN73350	2"	3.620	2.750	1.000	CG73350
CN73363	2 1/2"	4.540	3.260	1.200	CG73363
CN73375	3"	5.060	3.530	1.220	CG73375
CN733100	4"	6.080	3.950	1.430	CG733100